

WARREN COUNTY
EMPIRE ZONE:
AREA 5 DETAIL MAP

2005 Boundary Amendments
June 2006

KEY

- GRANDFATHERED BUSINESSES
- PARCEL BOUNDARIES
- EMPIRE ZONE AREAS

Data Sources:
- Municipal Boundaries: CUOR, 2005
- Parcel Boundaries: Warren County
- Zone Information: Warren County EDC
Note: Zone acreages are compiled from local assessor's database and GIS calculation. Totals are considered approximate.

PROJECT # 02059.18P
Copyright © 2006 Saratoga Associates. All rights Reserved.
This map is computer generated using data acquired by Saratoga Associates from various sources and is intended only for reference, conceptual planning and presentation purposes. This map is not intended for and should not be used to establish boundaries, property lines, location of objects or to provide any other information typically needed for construction or any other purpose when engineered plans or land surveys are required.

File Location: S:\GIS\02059\2005\Zone Area 5_Updated.mxd

SARATOGA
ASSOCIATES

Landscape Architects, Architects,
Engineers, and Planners, P.C.
1001 CHATELAIN ROAD, SUITE 200, SARATOGA, NY 12158

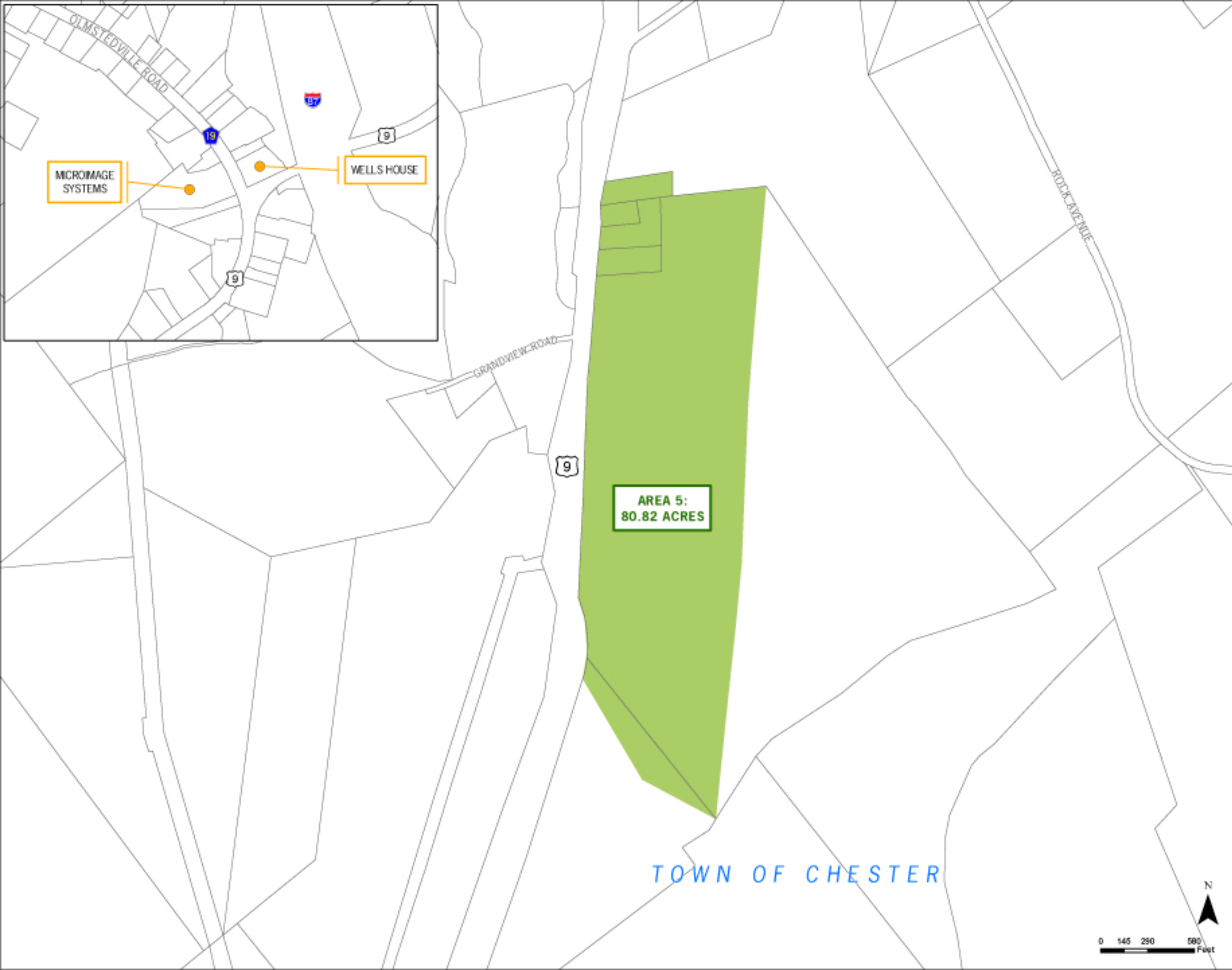

TOWN OF CHESTER

